

Endura Ultimate Trilennium® Compatible Astragal Strike Retainer

Replacement Instructions

Tools Required:



Phillips
Screwdriver

Camera may be helpful for
proper installation



Product Reference Guide:

Ultimate Trilennium® Compatible Astragal Anatomy

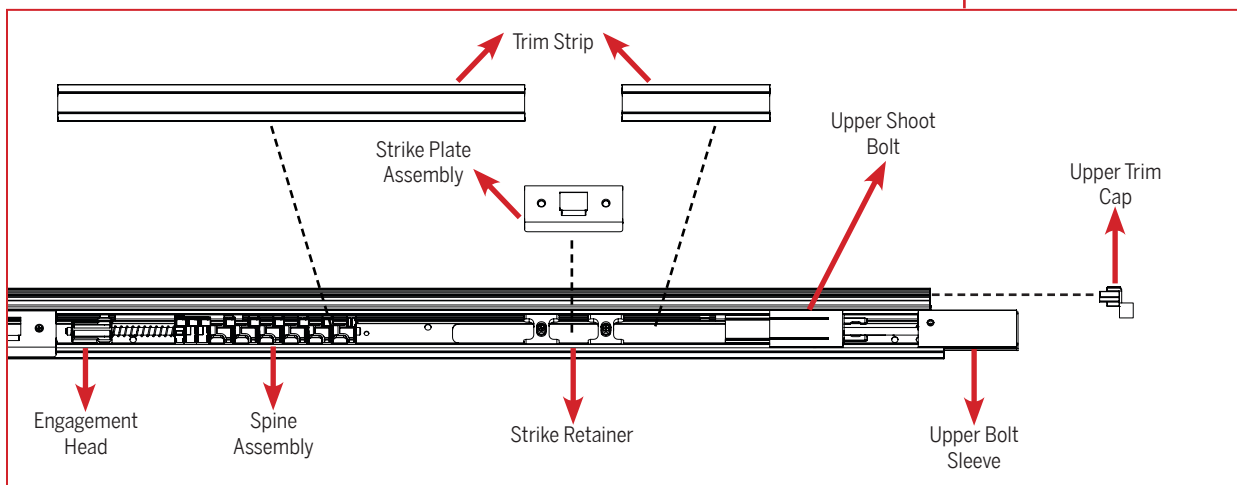

SKU: BD-INST-ETCA-STRET
Revised: 02.09.2017

8817 West Market Street, Colfax, NC 27235
800.334.2006 Fax: 336.668.4478
www.enduraproducts.com

STEP 1: REMOVE DOOR PANEL FROM JAMB

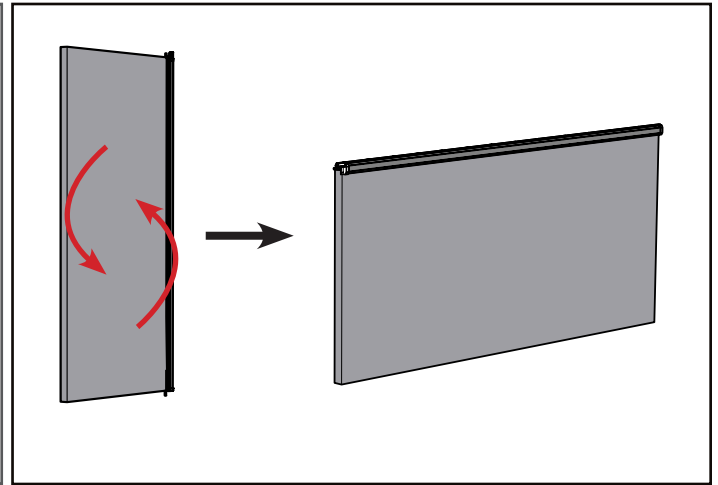
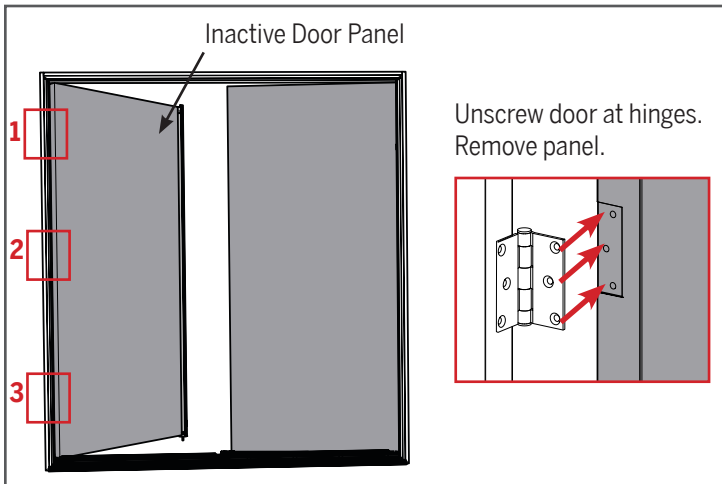

a. Remove the inactive door panel by unscrewing the door from the hinges.

b. Place the door panel horizontally against a strong support to access the astragal.

STEP 2: REMOVE COMPONENTS FROM ASTRAGAL

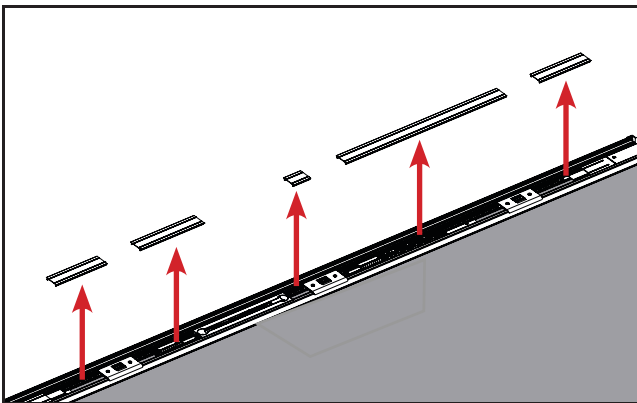

a. Remove the trim strip along the entire astragal body. Note where the 5 pieces of the trim strip belong, as you will have to return them to the exact position.

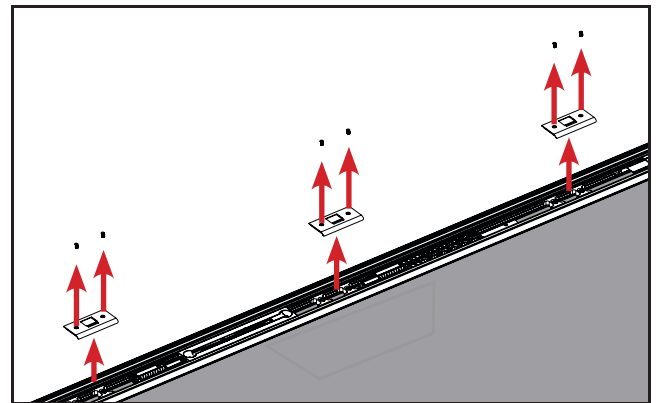

b. Unscrew the strike plates and remove.

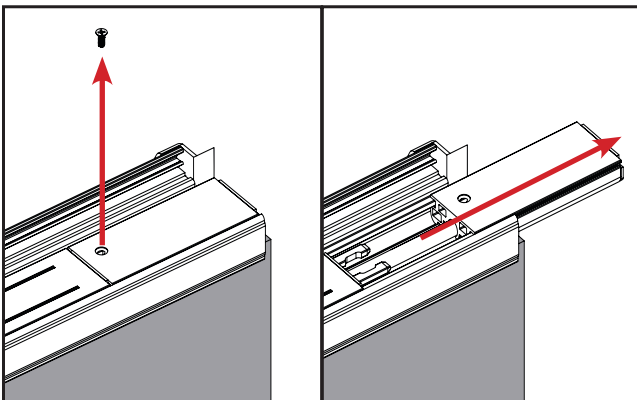

c. Unscrew and remove the bolt sleeves off the top and bottom bolts to reveal additional securing screws.

STEP 3: REMOVE THE SHOOT BOLT

If you are removing the **top** or **middle** strike retainers, remove the top bolts, spine assembly and strike retainer(s). If you are removing the **bottom** strike retainer, remove the bottom bolt and strike retainer. The below images show the steps for the removing the top bolts and spine assembly.

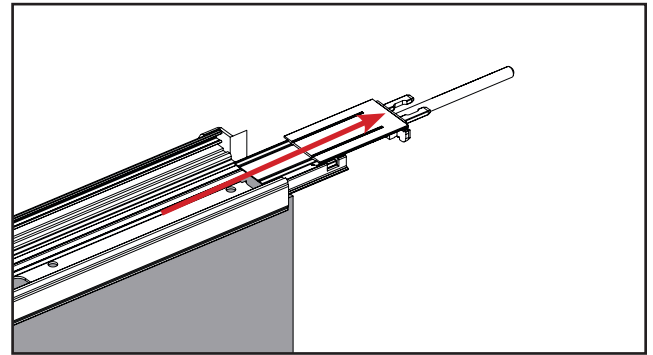
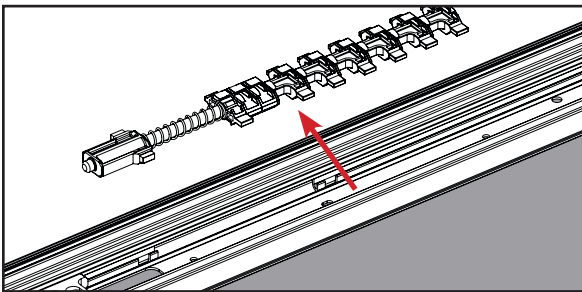
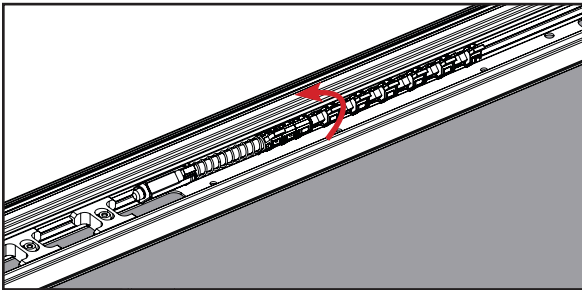
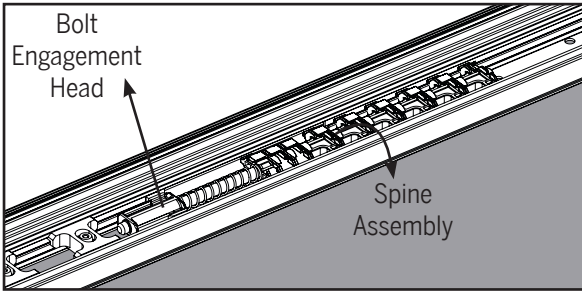

b. Slide out the metal driver rods from the astragal body, moving the upper shoot bolt with it.

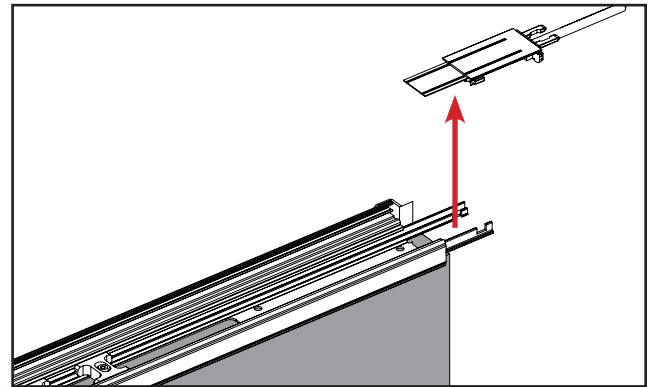

c. Remove the upper shoot bolt from the metal driver rods.

a. Rotate the engagement head and spine assembly in order to remove them from the metal driver rods.

Note the exact location and orientation of the spine assembly and the engagement head in order to reinstall correctly. We suggest taking a picture for reference.

STEP 4: REPLACE THE STRIKE RETAINER

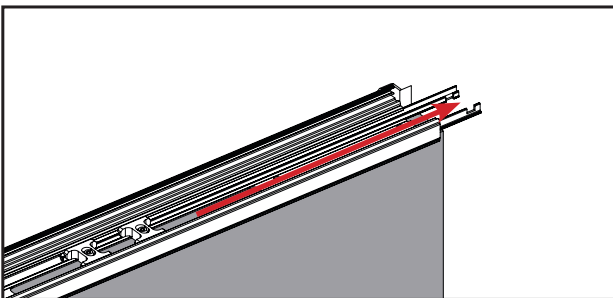

Remove the old strike retainer to be replaced from the astragal body.

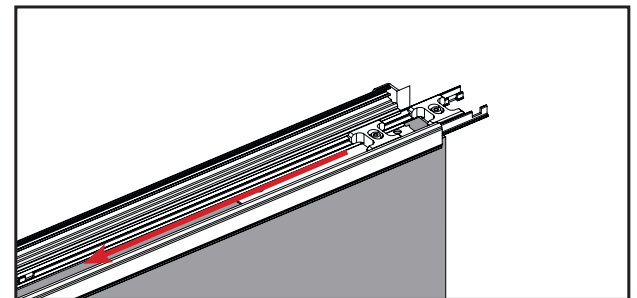

Slide the new strike retainer into the astragal body.

STEP 5: RETURN COMPONENTS IN PLACE

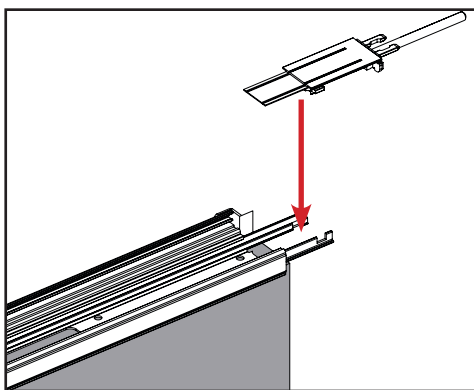

a. Return the shoot bolt so its engagement head notches securely into the grooves on the metal driver rods.

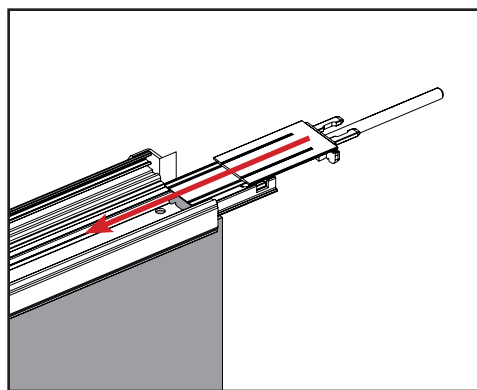
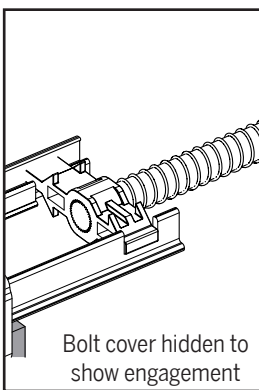

b. Slide the metal driver rods back into the astragal body, along with the shoot bolt.

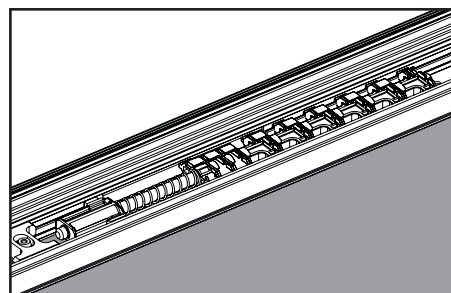
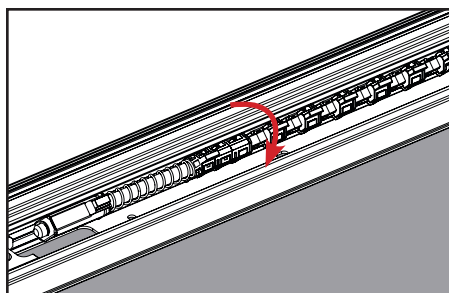
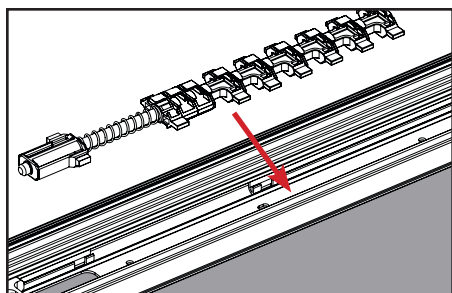

c. Replace the spine assembly in the exact location it was removed from. Align the bolt engagement head into the metal driver rods and rotate the spine assembly into the astragal body.

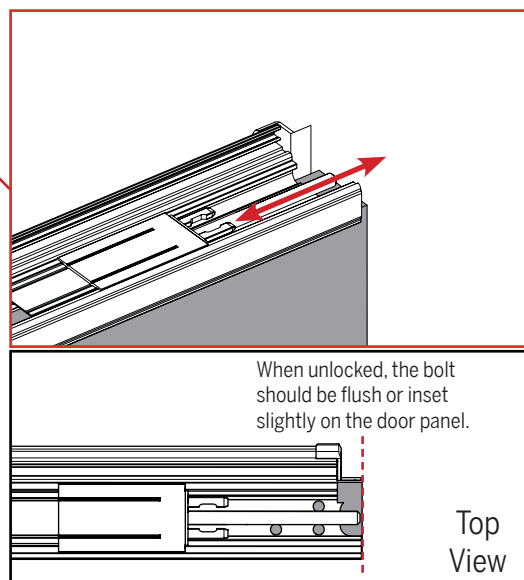
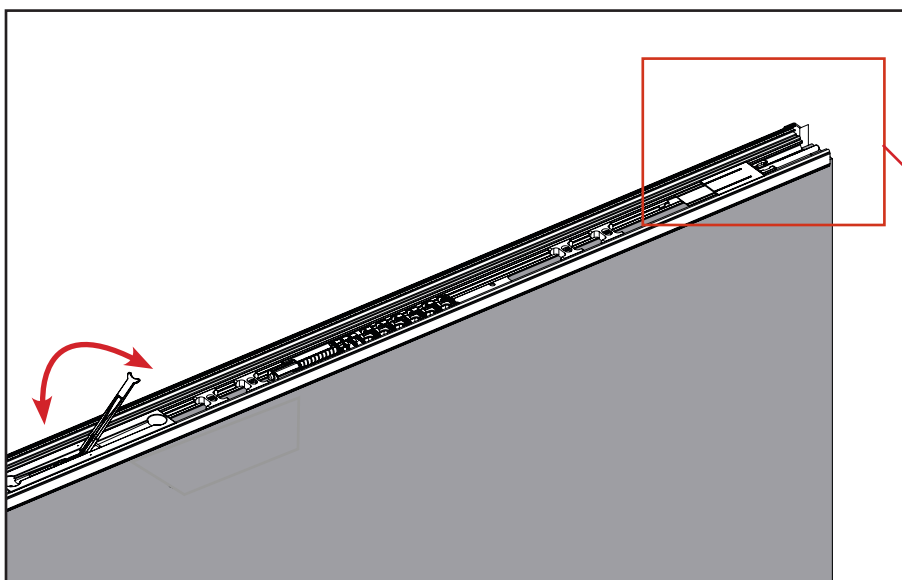

d. Check operation of the flip lever assembly and shoot bolts. When the flip lever is in the unlocked position, the end of the bolt must be either flush with the astragal body or slightly inset. When the flip lever is in the locked position, ensure the entire spine assembly and shoot bolt extend together.

STEP 6: REPLACE STRIKE PLATES

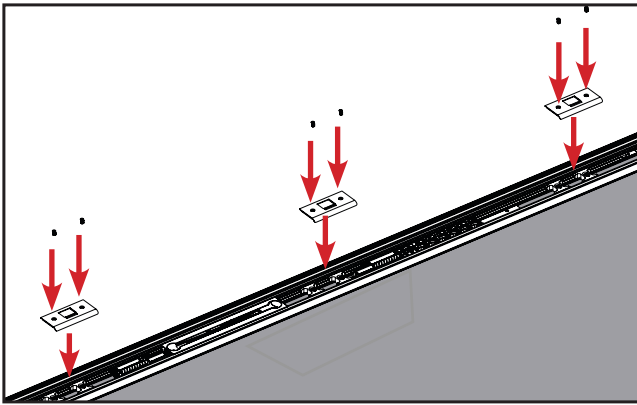

Return the strike plates on the retainers and screw back in place.

STEP 7: RETURN COMPONENTS

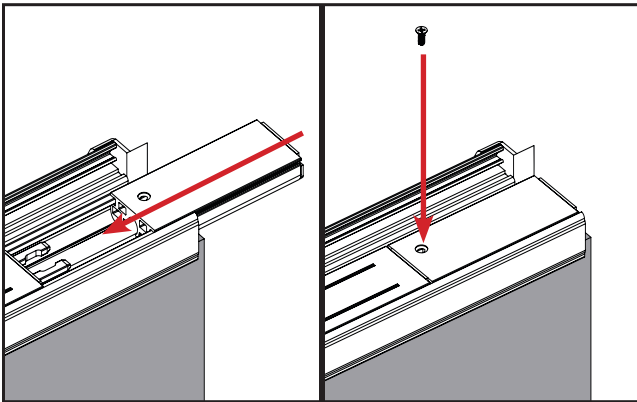

a. Return the bolt sleeves to the top and bottom of the astragal and secure them with the screws previously removed.

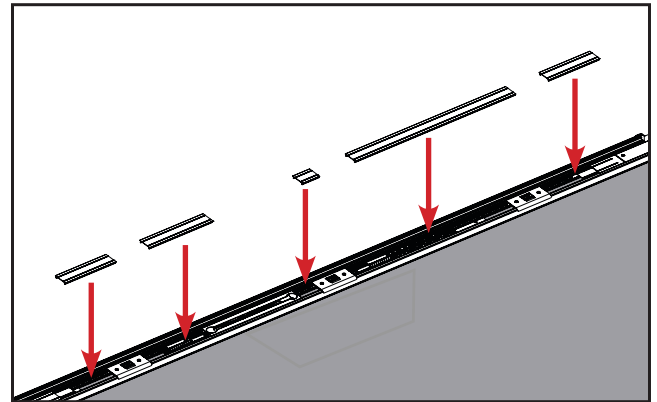

b. Return the trim strip on the door in the same locations that they originally were. Use this to guide adjust where the strike retainer will sit.

STEP 8: REINSTALL DOOR PANEL ON JAMB

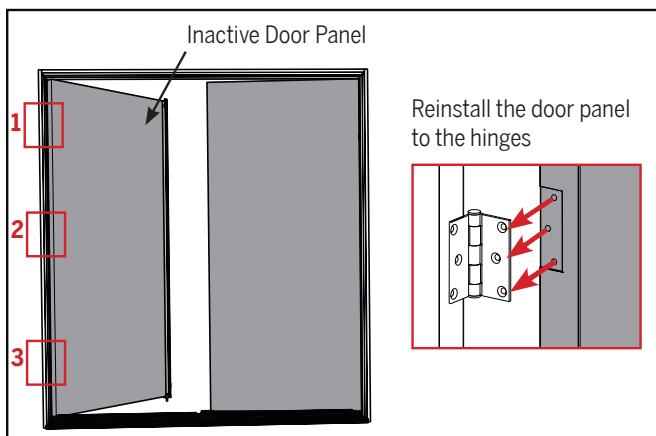

a. Reinstall the inactive door panel by screwing the door panel back to the hinges.

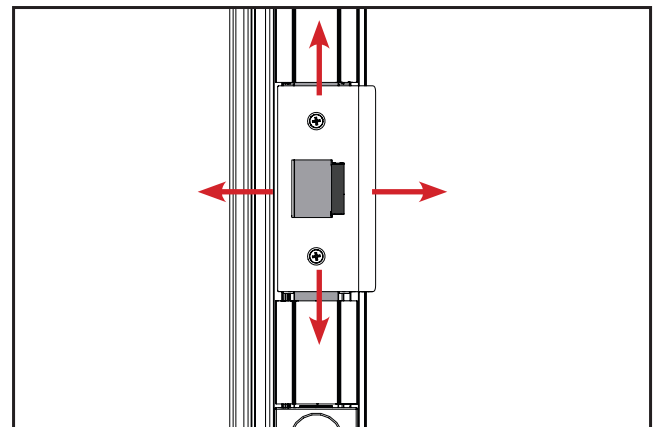

b. Adjust the location of the plates if necessary by loosening the screws and sliding the plate horizontally.