

# Endura Multi-Point Astragal Strike Retainer

## Replacement Instructions

### Tools Required:



Phillips  
Screwdriver

Camera may be helpful for  
proper installation



### Product Reference Guide: Multi-Point Astragal Anatomy

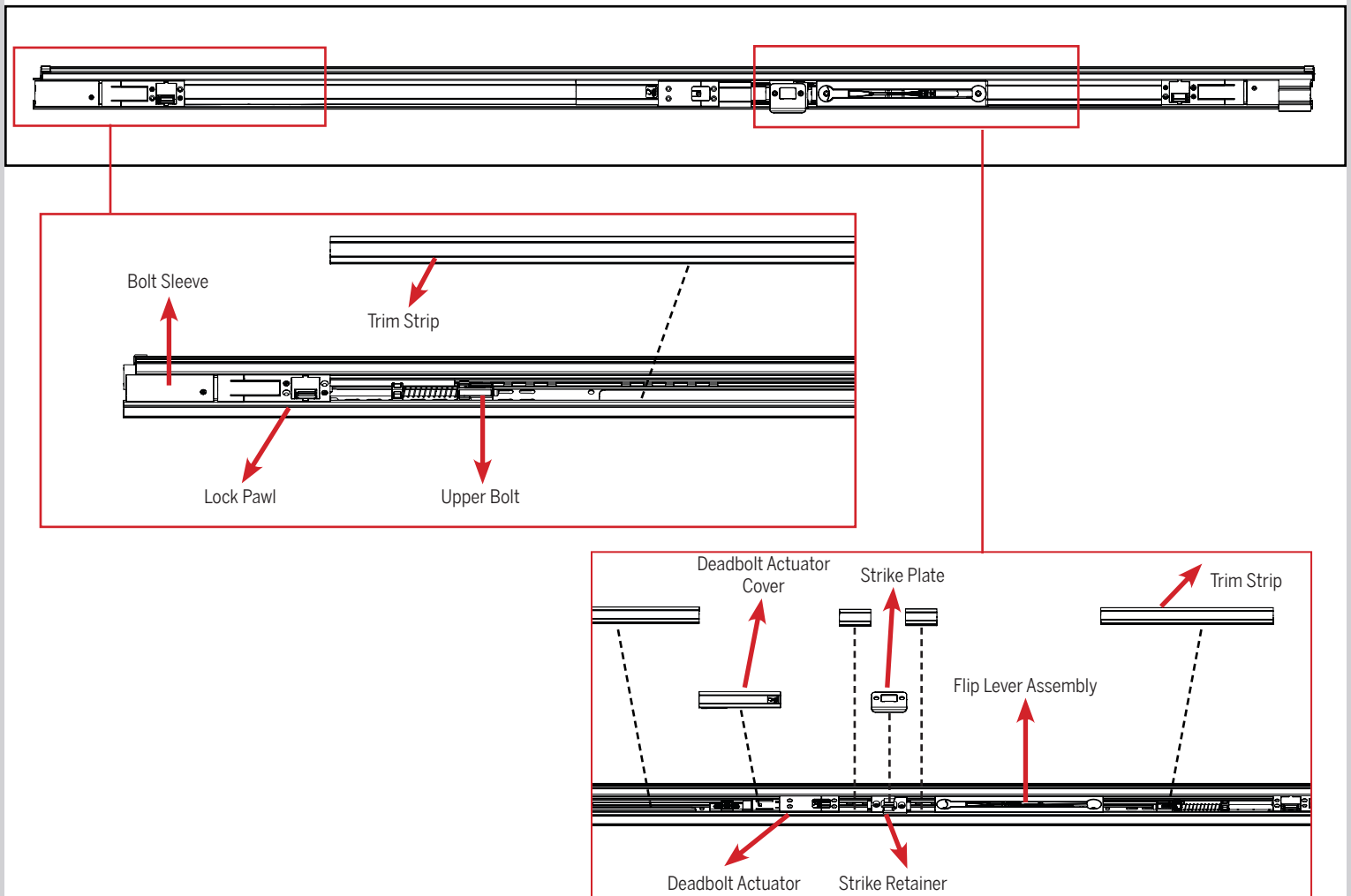

## STEP 1: REMOVE DOOR PANEL FROM JAMB

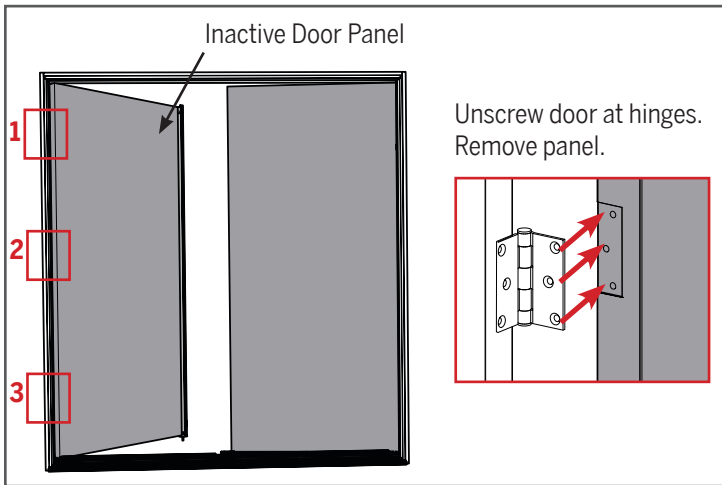

a. Remove the inactive door panel by unscrewing the door from the hinges.

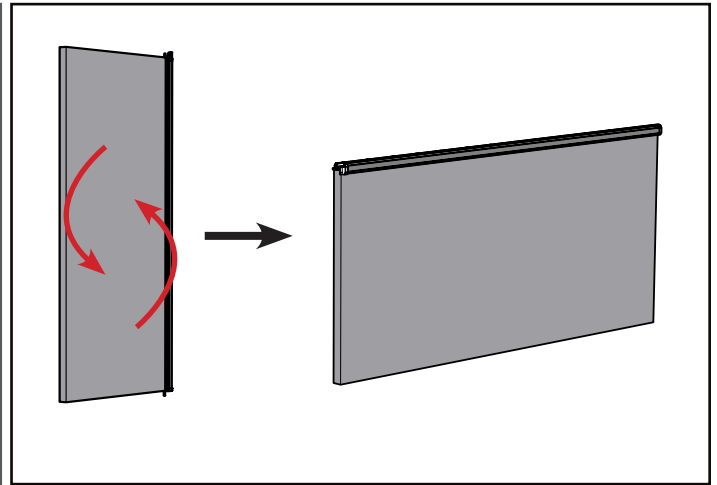

b. Place the door panel horizontally against a strong support to access the astragal.

## STEP 2: REMOVE ASTRAGAL FROM DOOR PANEL

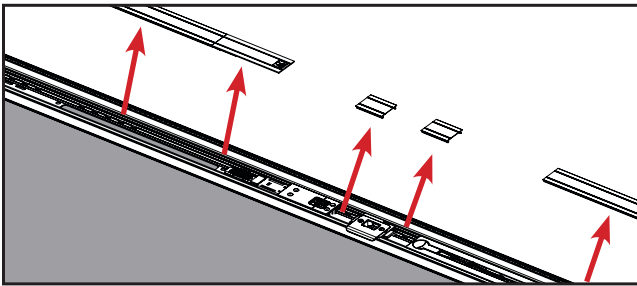

a. Remove the trim strip and the actuator cover along the entire astragal body. Note where the trim strip pieces belong, as you will have to return them to the exact position.

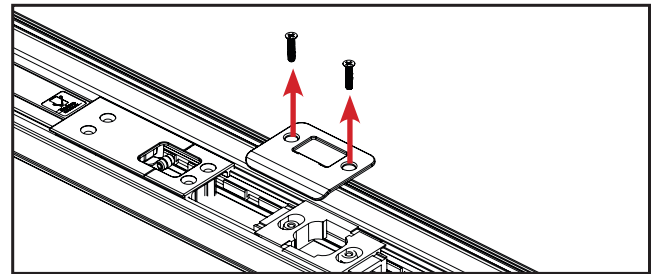

b. Unscrew the strike plate and remove.

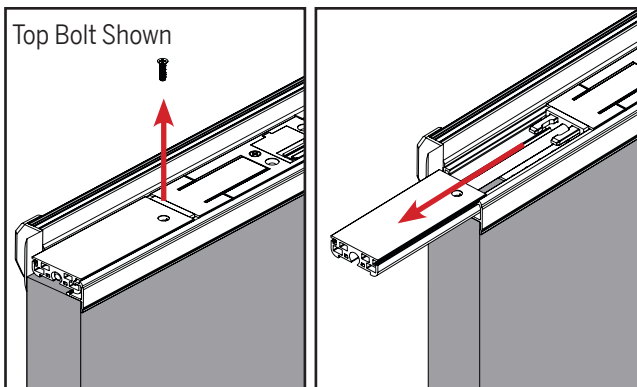

c. Unscrew and remove the bolt sleeves off the top and bottom bolts to reveal additional securing screws.

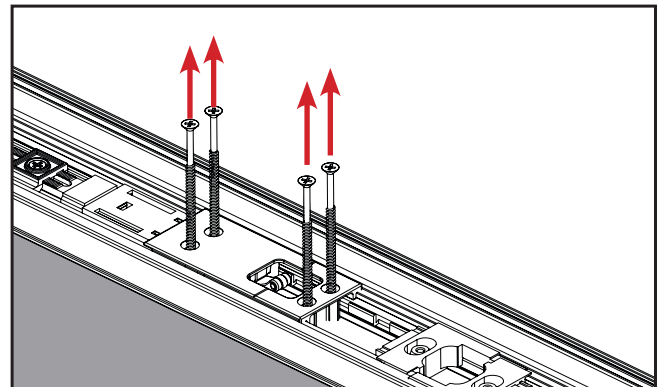

d. Remove the screws securing the deadbolt actuator through to the door panel.

## STEP 2 (CONT.): REMOVE ASTRAGAL FROM DOOR PANEL

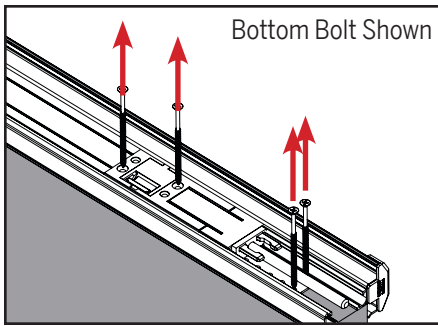

e. Remove the screws securing the astragal to the door panel. The astragal may still be attached to the panel due to the presence of a strong tape adhering it to the panel.

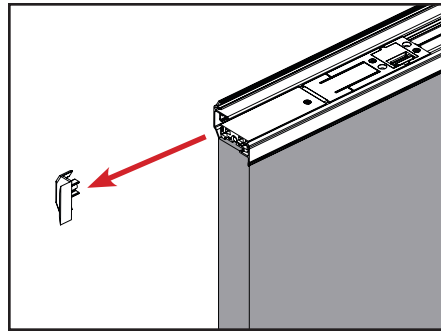

f. If still attached, remove the trim cap on the top of the door exposing a channel to grasp the astragal.

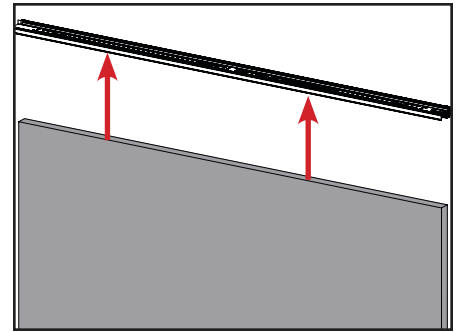

g. Pry the astragal off of the door panel. **We recommend you use help to do this.**

## STEP 3: REMOVE THE ACTUATOR

Before sliding the actuator and bolt out of the channel in the next steps, note where it sits along the operating rod as you will need to return both to the exact location (We suggest taking a picture for reference during reassembly).

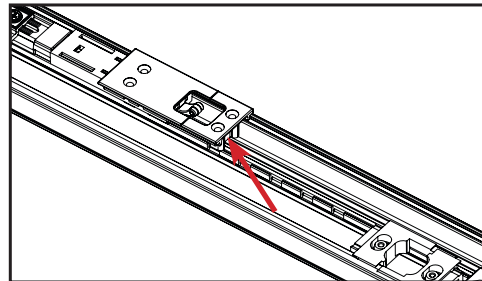
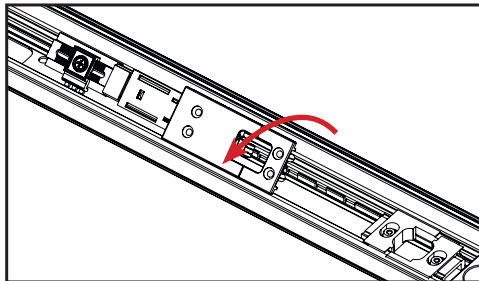

Remove the deadbolt actuator by rotating the engagement head out of the channel and lifting.

## STEP 4: REMOVE THE UPPER SHOOT BOLT

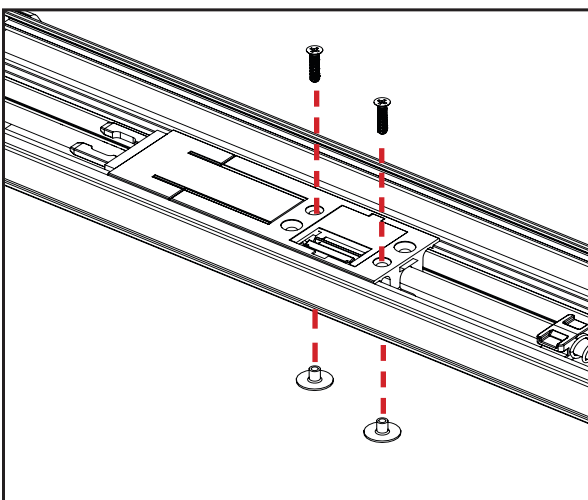

a. Loosen and remove screws that hold the bolt in place. T-nuts hold the screws on the back side of the astragal. Remove these and set aside.

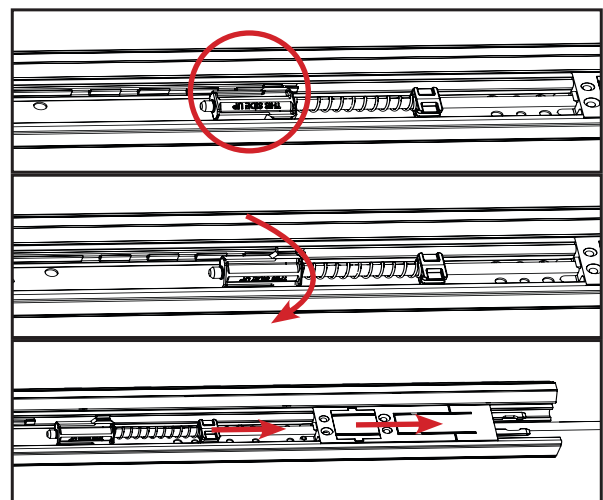

b. Slide the shoot bolt out by first angling the white head out of the channel and then sliding out of the astragal body.

## STEP 5: REPLACE THE STRIKE RETAINER

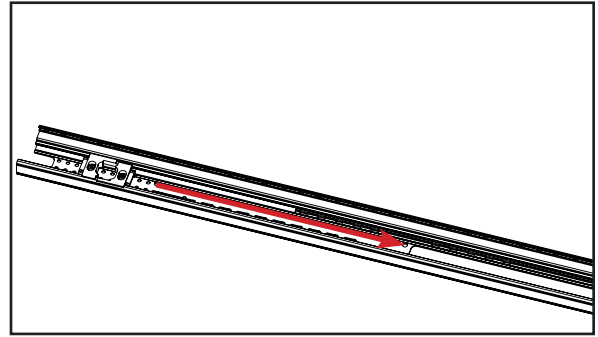
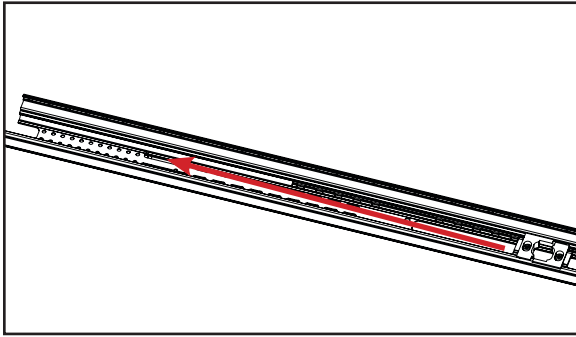

Slide the strike retainer out of the astragal, and replace by sliding a new one in its place.

## STEP 6: RETURN COMPONENTS ON ASTRAGAL

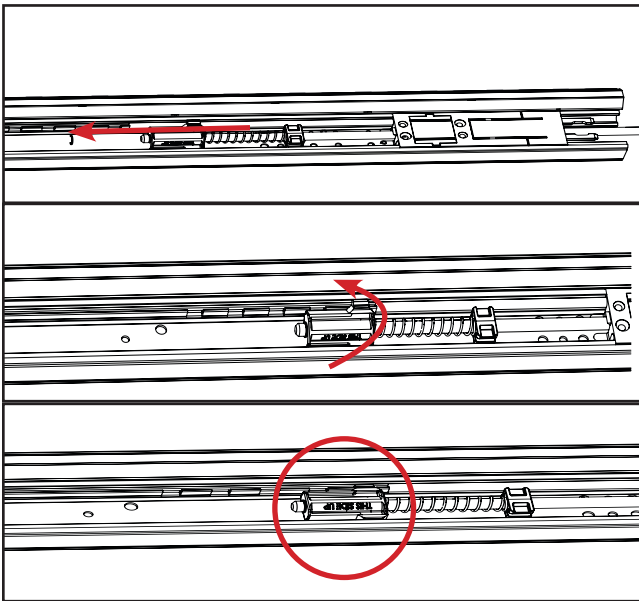

a. Return the shoot bolt into the astragal in the exact position that you removed it from by angling and placing the white head into the channel.

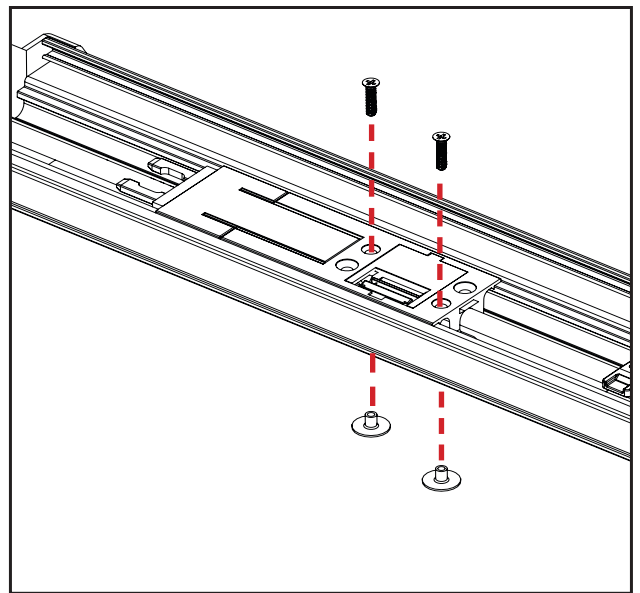

b. Return the top shoot bolt and screw in place using the T-nuts and smaller screws in the smaller screw holes.

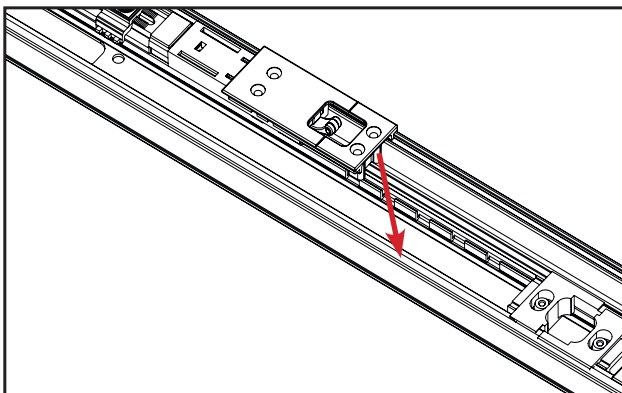

c. Return the actuator to its exact location on the operating channels and screw into place.

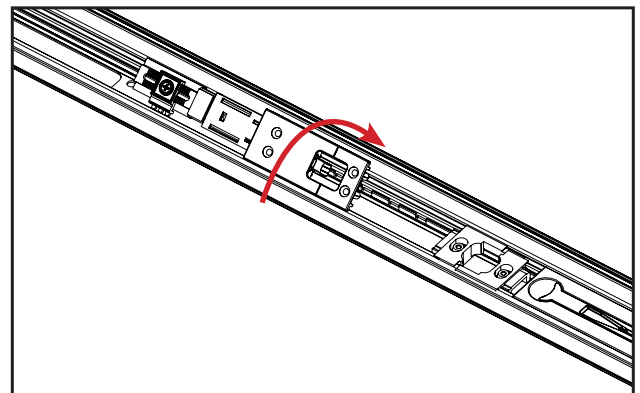

## STEP 6 (CONT.): RETURN COMPONENTS ON ASTRAGAL

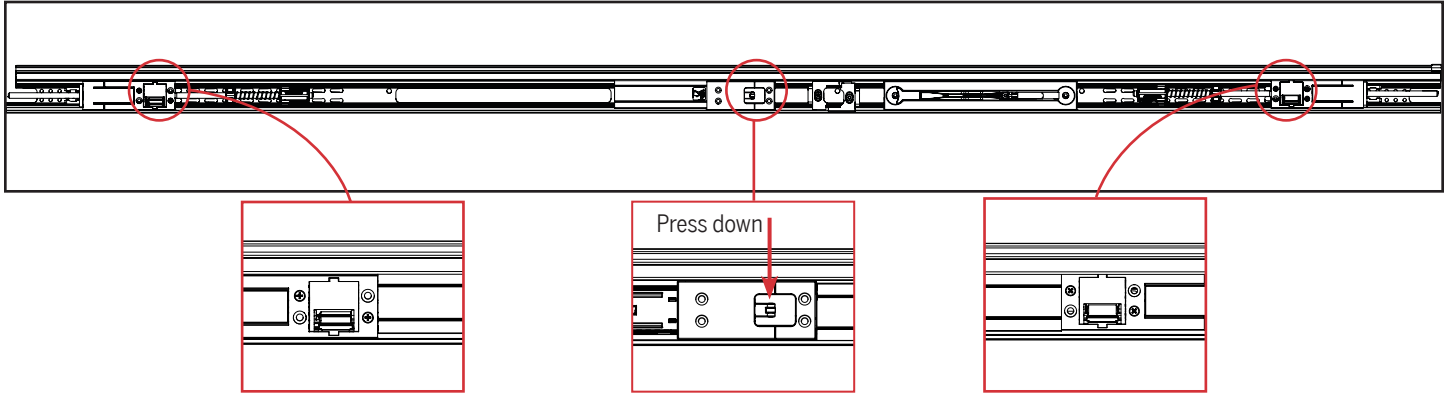

d. Press down on the actuator to ensure it engages the top and bottom lock pawls. Adjust the engagement head if necessary.

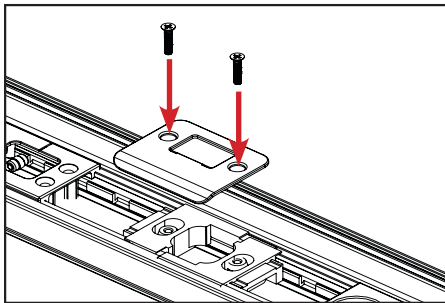

e. Return strike plate onto the retainer and screw back in place.

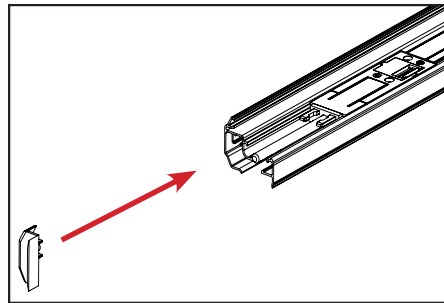

f. Return the trim cap on the ends of the astragal.

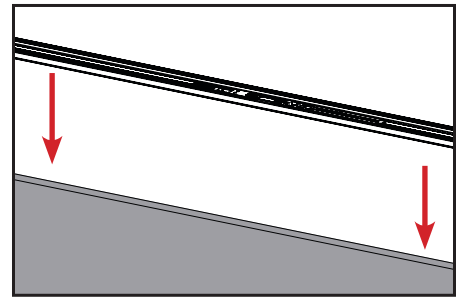

g. Return the astragal to the door panel and screw into place, returning all of the screws removed previously from the door panel.

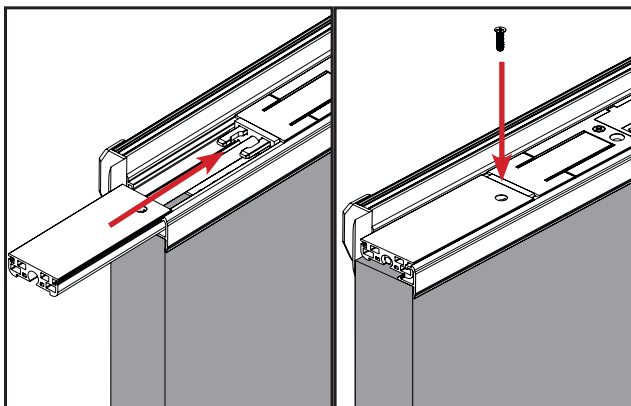

h. Return the bolt sleeves to the top and bottom of the astragal and secure them with the screws previously removed.

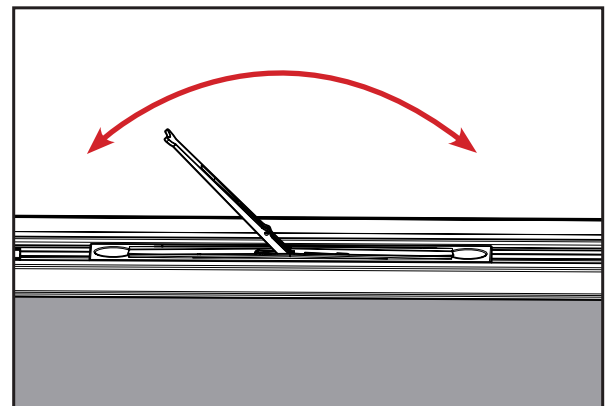

i. Operate the flip lever to ensure the bolt is actively engaged. Ensure that when the flip lever is in the unlocked position, the end of the bolt is either flush with the end of the astragal body or slightly inset.

## STEP 6 (CONT.): RETURN COMPONENTS ON ASTRAGAL

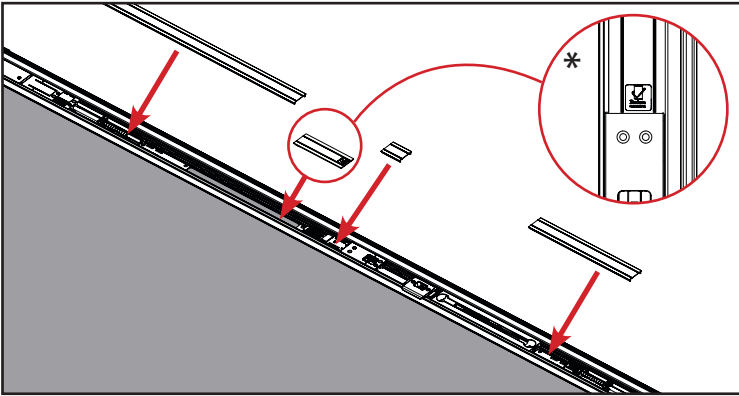

\*Return actuator cover ensuring the logo side is towards the bottom of the door.

j. Return the trim strip on the door in the same locations that they originally were. Use this as a guide to adjust where the strike retainer will sit.

## STEP 7: REINSTALL DOOR PANEL ON JAMB

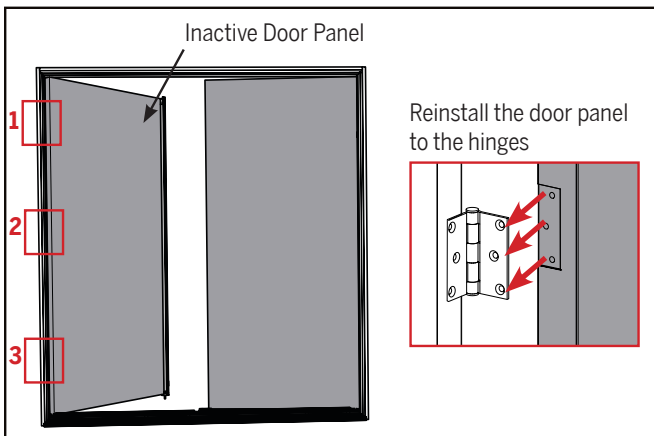

a. Reinstall the inactive door panel by screwing the door panel back to the hinges.

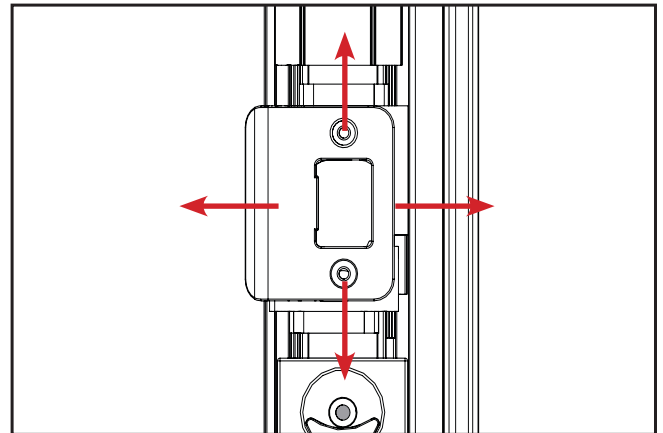

b. Loosen screws and adjust the plate and retainer location, if necessary.