

Endura Multi-Point Astragal Deadbolt Actuator

Replacement Instructions



8817 West Market Street, Colfax, NC 27235
800.334.2006 Fax: 336.668.4478
www.enduraproducts.com

We are here to help!

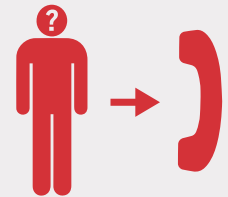

ENDURA PRODUCTS
1.800.334.2006

Tools Required



Pencil

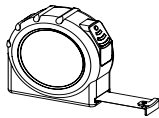

Tape Measure



Phillips
Screwdriver



Flathead
Screwdriver

Kit Includes



- Deadbolt Actuator with cover
- Securing Screws (4)

Product Reference Guide: Multi-Point Astragal Anatomy

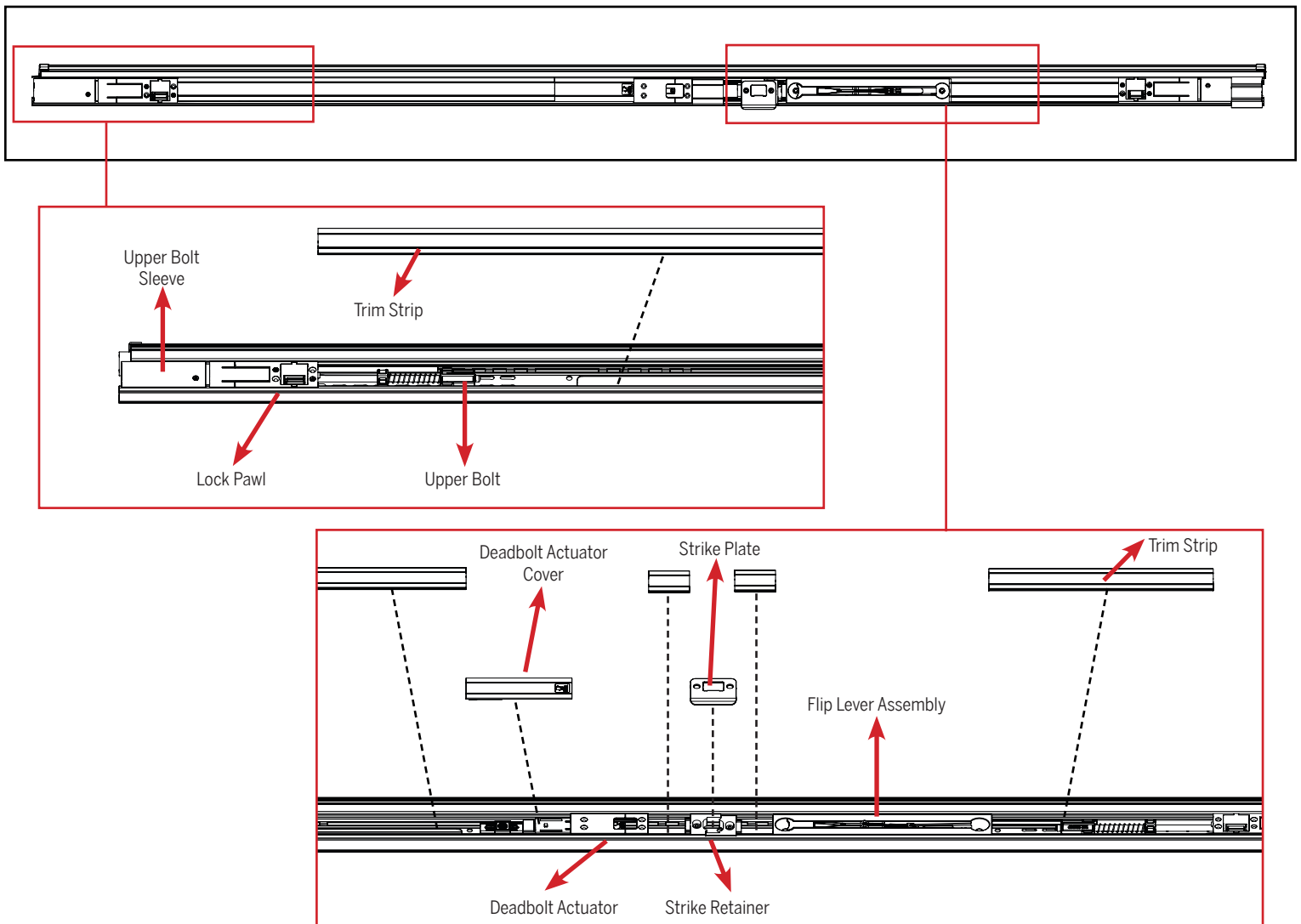

SKU: BD-MPA-DBACTUATOR
Revised: 02.14.2017

STEP 1: REMOVE INACTIVE DOOR PANEL FROM JAMB

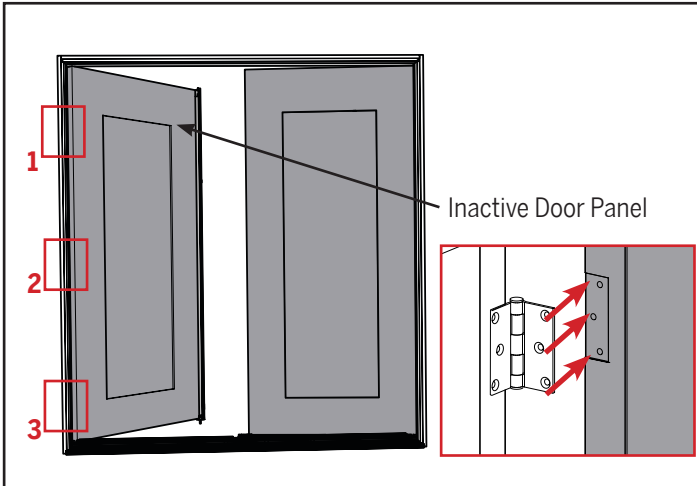

1a. Remove inactive panel by unscrewing at the hinges.

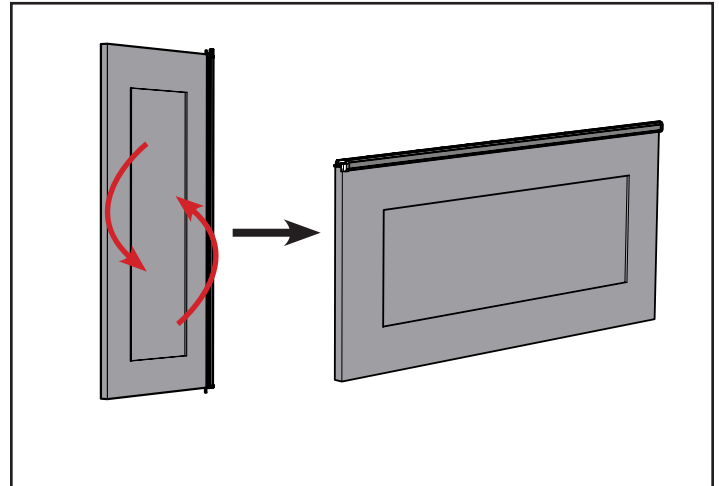

1b. Place the door panel horizontally against a strong support to access the astragal.

STEP 2: REMOVE DEADBOLT ACTUATOR TO BE REPLACED

* Door panel hidden in following images. Only astragal shown, for clarity.

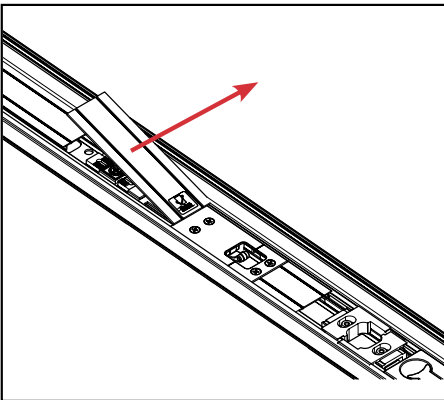

2a. Remove the actuator cover adjacent to the deadbolt actuator.

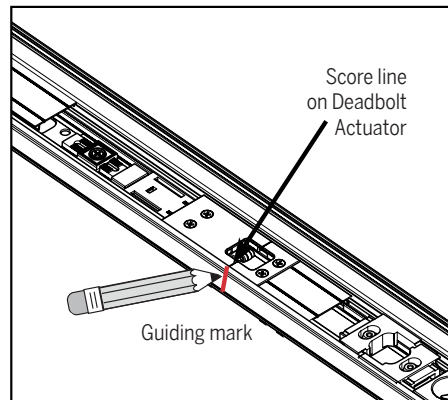

2b. Make a mark on the side of the astragal body along the score line on the deadbolt actuator.

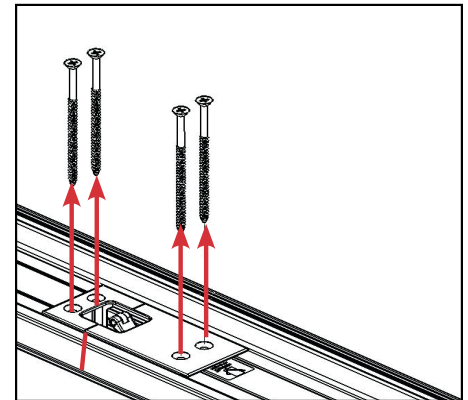

2c. Remove 4 securing screws from the deadbolt actuator.

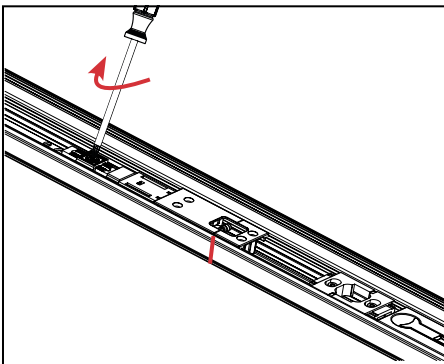

2d. Loosen screw on black engagement head.

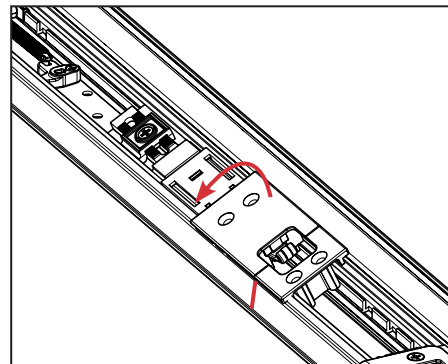

2e. Rotate the deadbolt actuator towards the narrow side of the astragal and remove.

STEP 3: REPLACE THE DEADBOLT ACTUATOR

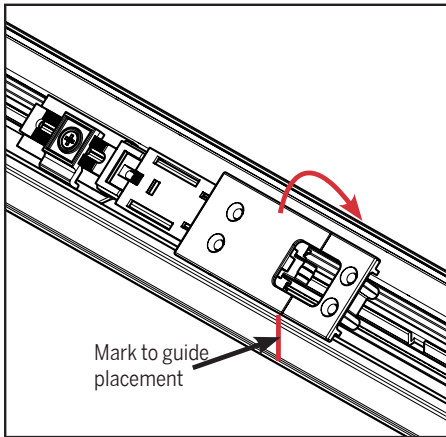

3a. Carefully align the scribe line on deadbolt actuator to the original position on the astragal.

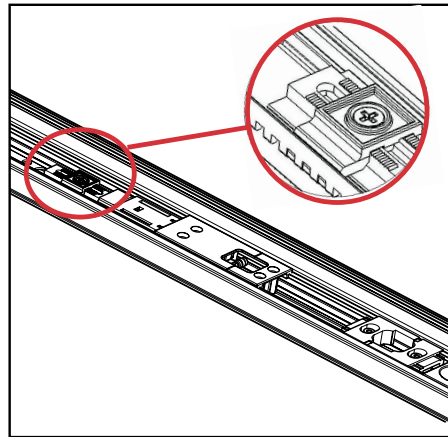

3b. Ensure the engagement head engages with the teeth on the linkage bar in the astragal.

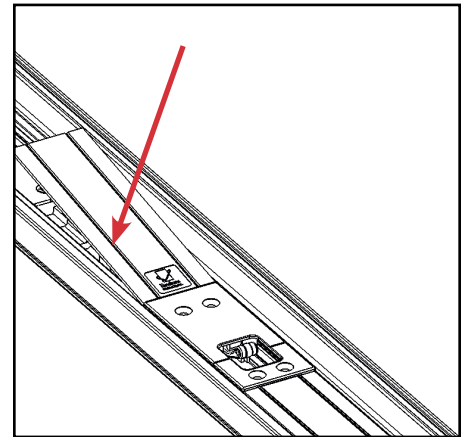

3c. Replace the actuator cover.

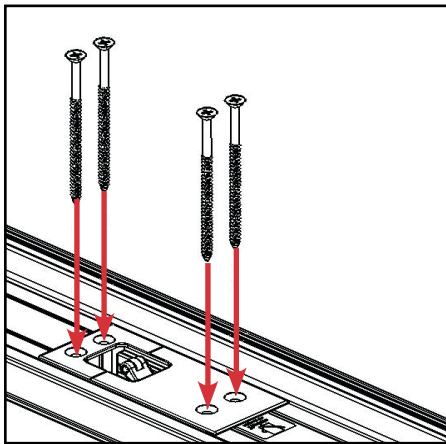

3d. Return the 4 securing screws into the deadbolt actuator.

STEP 4: REINSTALL DOOR ON JAMB

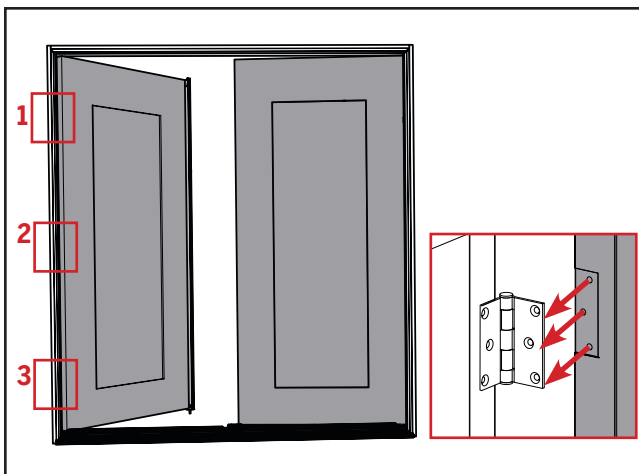

Return door panel on jamb.

Confirm Operation:

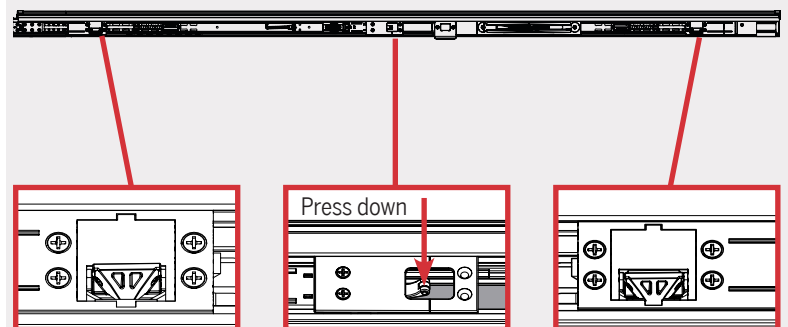

Press the cam actuator down and ensure the lock pawls on the upper and lower bolts of the astragal move synchronously.