

Endura Astragal Strike and Deadbolt Plates

Replacement Instructions

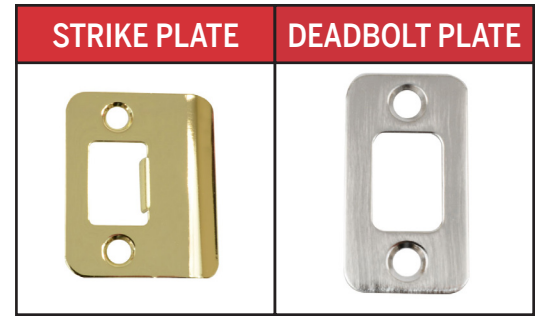

Tools Required:

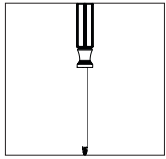

Phillips
Screwdriver

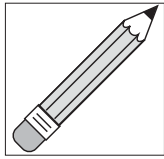

Pencil

STEP 1: PREPARE ASTRAGAL FOR NEW PLATES

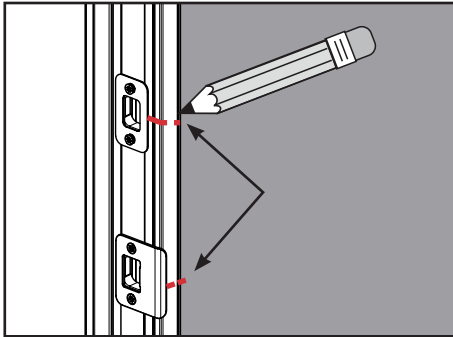

a. Mark the center line of the plate opening(s) on the edge of the astragal body.

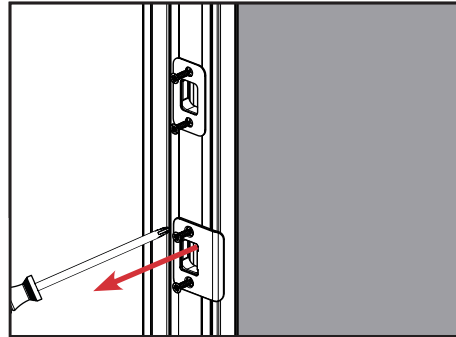

b. Unscrew and discard the old plate(s).

STEP 2: INSTALL NEW PLATES

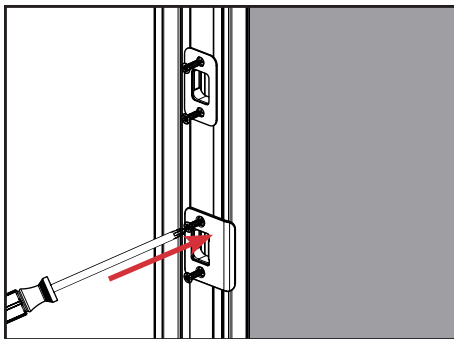

a. Attach the new plates, ensuring the opening center aligns with the marking from Step 1a.

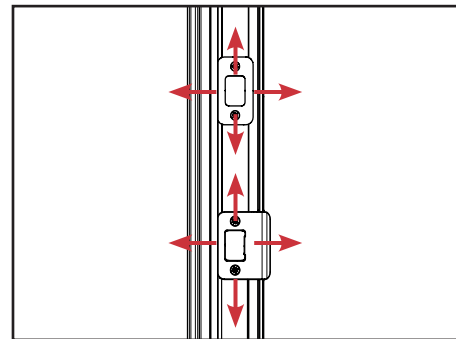

b. Close the active door to ensure latch and deadbolt properly engage. Loosen strike plate screws and adjust plate position as necessary for proper engagement. Wipe off pencil mark when complete.



8817 West Market Street, Colfax, NC 27235
800.334.2006 Fax: 336.668.4478
www.enduraproducts.com

SKU: BD-INST-ASTPLATES
Revised: 02.13.2017