

# Endura Ultimate Trilennium® Compatible Astragal Shoot Bolt

## Installation Instructions

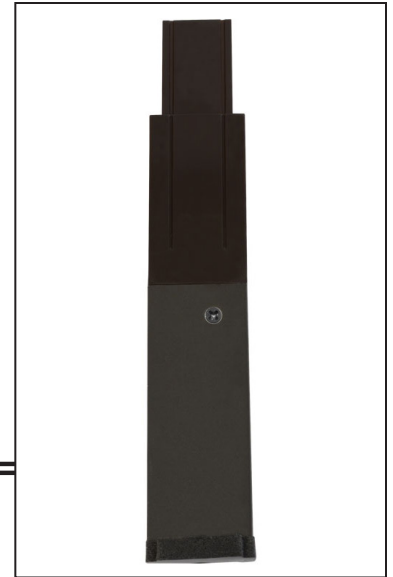

### Tools and Supplies:

- Phillips Screw Driver
- Pliers

**Note:** This kit includes an upper or lower shoot bolt. If you are replacing the lower shoot bolt, you will also need to replace the corner pad on the shoot bolt. For maximum performance, we recommend that you use the Endura Simple Solution™ Corner Pad.

## STEP 1: REMOVE DOOR PANEL FROM JAMB

To replace the shoot bolt, you will need to remove the inactive door panel off the frame. **We recommend you use assistance for this step.**

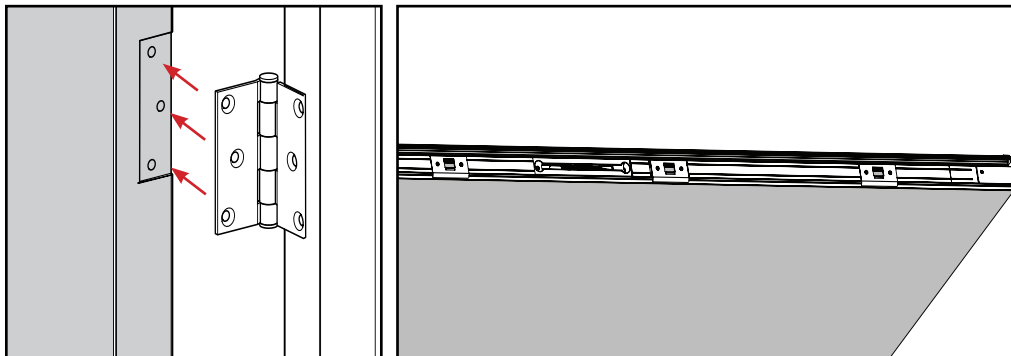

Remove the inactive door panel by loosening and removing screws from the hinges. Place the panel vertically against a strong support to gain easy access to the astragal.

## STEP 2: REMOVE COMPONENTS FROM ASTRAGAL

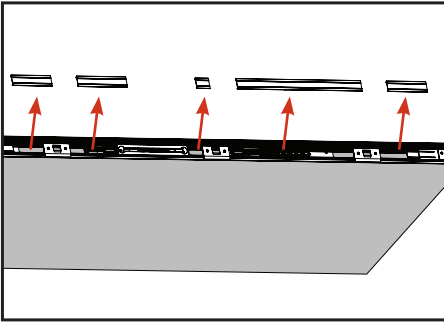

a. Remove the trim strip along the entire astragal body. Note where the 5 pieces of the strip belong, as you will have to return them to the exact position.

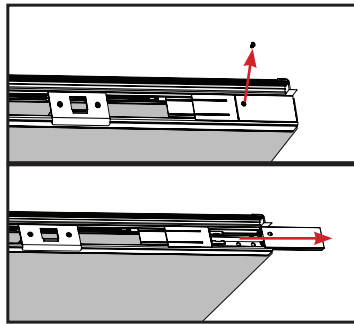

b. Unscrew and remove the bolt sleeves off the top and bottom bolts to reveal additional securing screws.

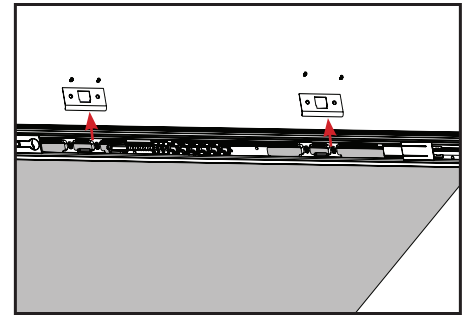

c. Unscrew the strike plate and remove.

## STEP 3: REMOVE THE SHOOT BOLT

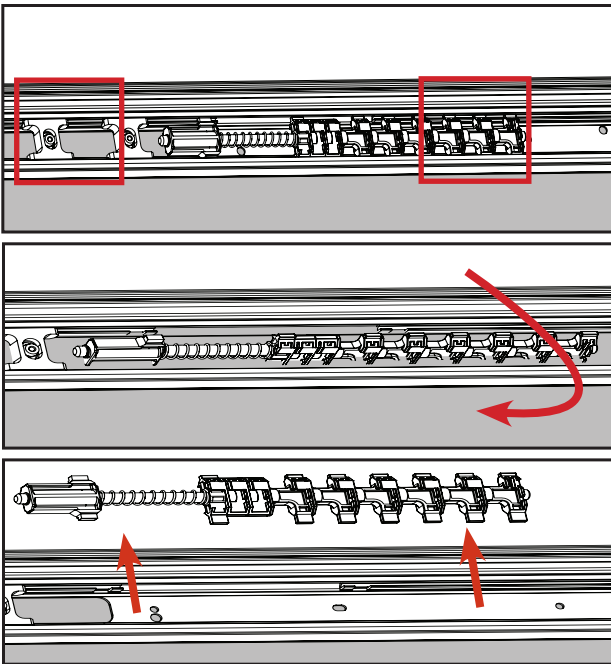

a. Remove the spine assembly and engagement head in order to freely slide the metal driver channels out of the astragal. Angle the engagement head and the spine assembly and remove from the channel.

**\*\***Note the exact location and orientation of the spine assembly and the engagement head in order to reinstall correctly. We suggest taking a picture for reference.

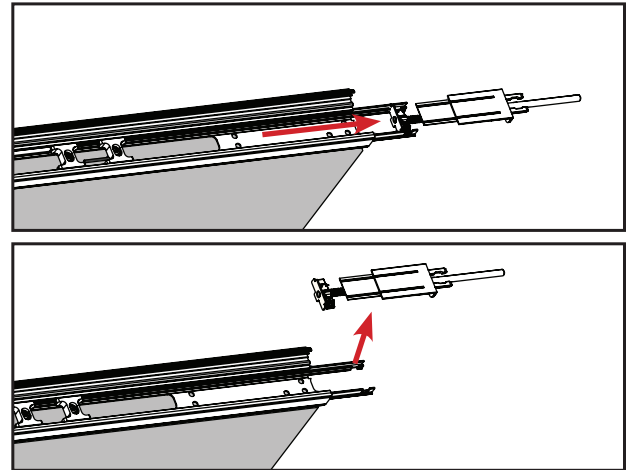

b. Slide out the upper metal driver rods and remove the shoot bolt.

## STEP 4: RETURN COMPONENTS INTO ASTRAGAL

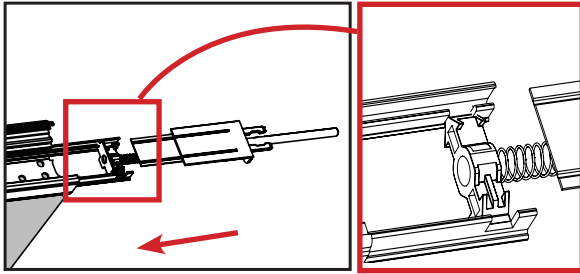
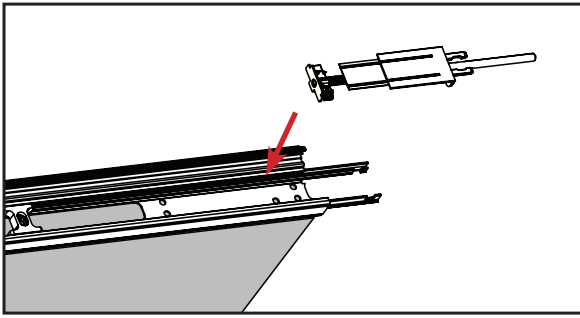

a. Return the shoot bolt so its engagement head notches securely in to the grooves on the metal driver rods. Slide the rods back in place.

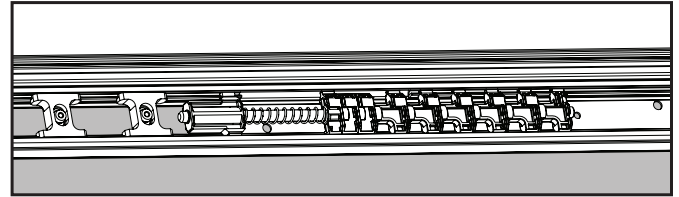
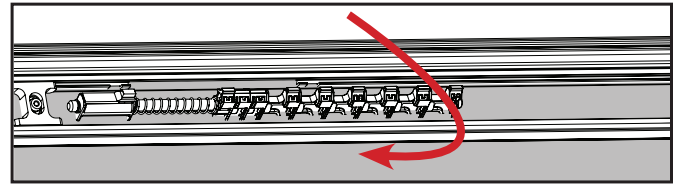
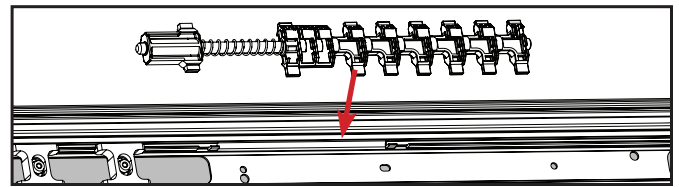

b. Replace the spine assembly in the exact location it was removed from. Confirm correct installation by engaging the flip lever and ensuring the rods operate smoothly.

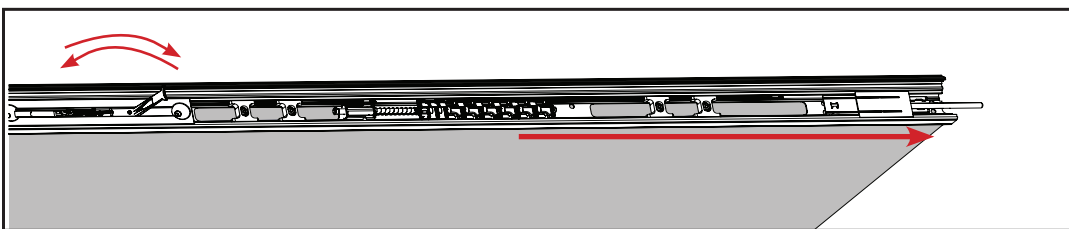
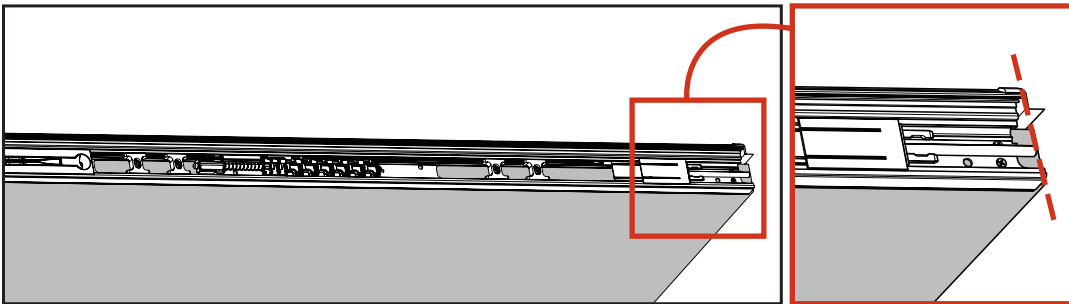

c. Confirm smooth operation of the bolt and spine assembly - When the flip lever is in the unlocked position, the end of the bolt must be either flush with the astragal body or slightly inset. When engaged, in the locked position, ensure the entire assembly of the spine and the shoot bolt move out as a unit.

## STEP 5: RETURN COMPONENTS AND REINSTALL DOOR PANEL

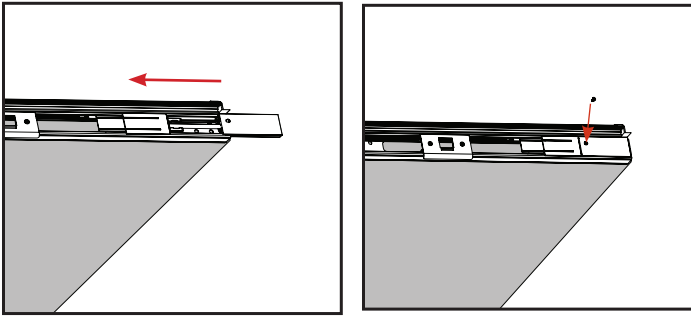

a. Return bolt sleeves. Ensure that in the disengaged or unlocked state, the end of the bolt is flush with the end of the astragal body.

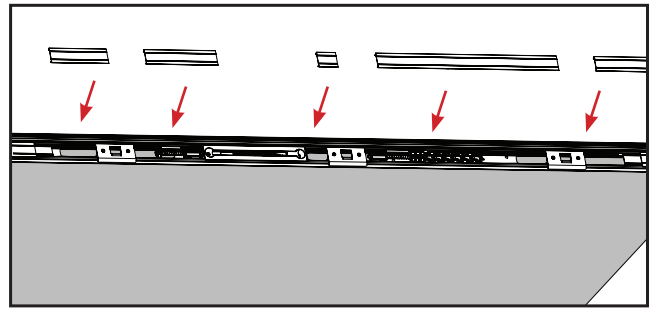

b. Return the trim strip on the door in the same locations that they originally were. Use this to guide adjust where the strike retainer will sit.

## STEP 6: REINSTALL DOOR PANEL ON JAMB

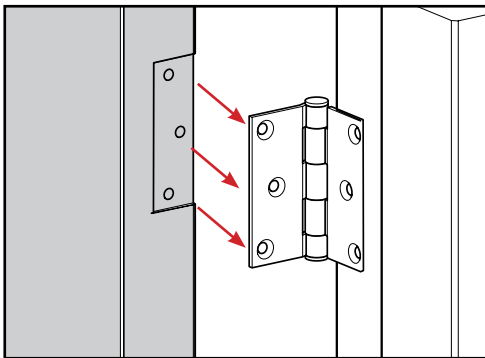

a. Return door panel to the jamb and screw back onto hinges. Close and lock the active door to ensure proper engagement of the dead bolt and latch with the dead bolt plate and strike plate. **We recommend you use assistance for this step.**

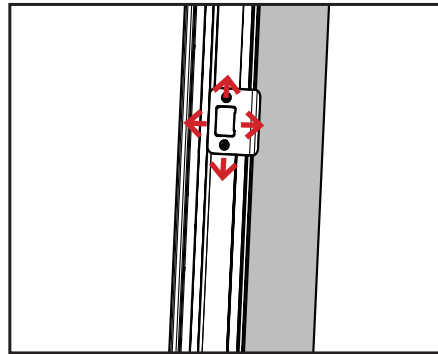

b. Adjust the location of the plates if necessary by loosening the screws and sliding the plate horizontally.